

# Custom Hearing Device

## Inserting and Replacing the Battery

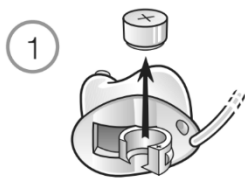

1 To remove the old battery, open the battery door of the hearing aid and lift the battery out of the drawer.

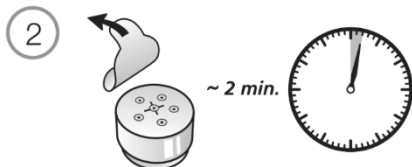

2 Peel the sticky label off the new battery and leave exposed to the air for about 2 minutes to fully activate the battery.

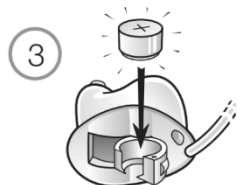

3 Insert the new battery into the hearing aid battery drawer with the + sign on the battery matching the + sign on the battery door.

- Your hearing devices should give an intermittent warning beep every few minutes when the batteries are running low. The low-battery warning beeps indicate about 30 minutes of battery power remaining.
- If you find it difficult to remove the old battery, use a pen to push the battery out from the underside of the battery drawer.
- Hearing device batteries are air-activated - only remove the sticky label immediately before using the battery and expose to the air for at least 1 minute before inserting into the hearing device.
- The battery door should close easily - if the battery door is not closing properly, this usually means the battery is the wrong way around.